

STANDARD CANOPY IP-175 ORIENTAL SPAREPARTS

REQUEST PARTS ONLINE

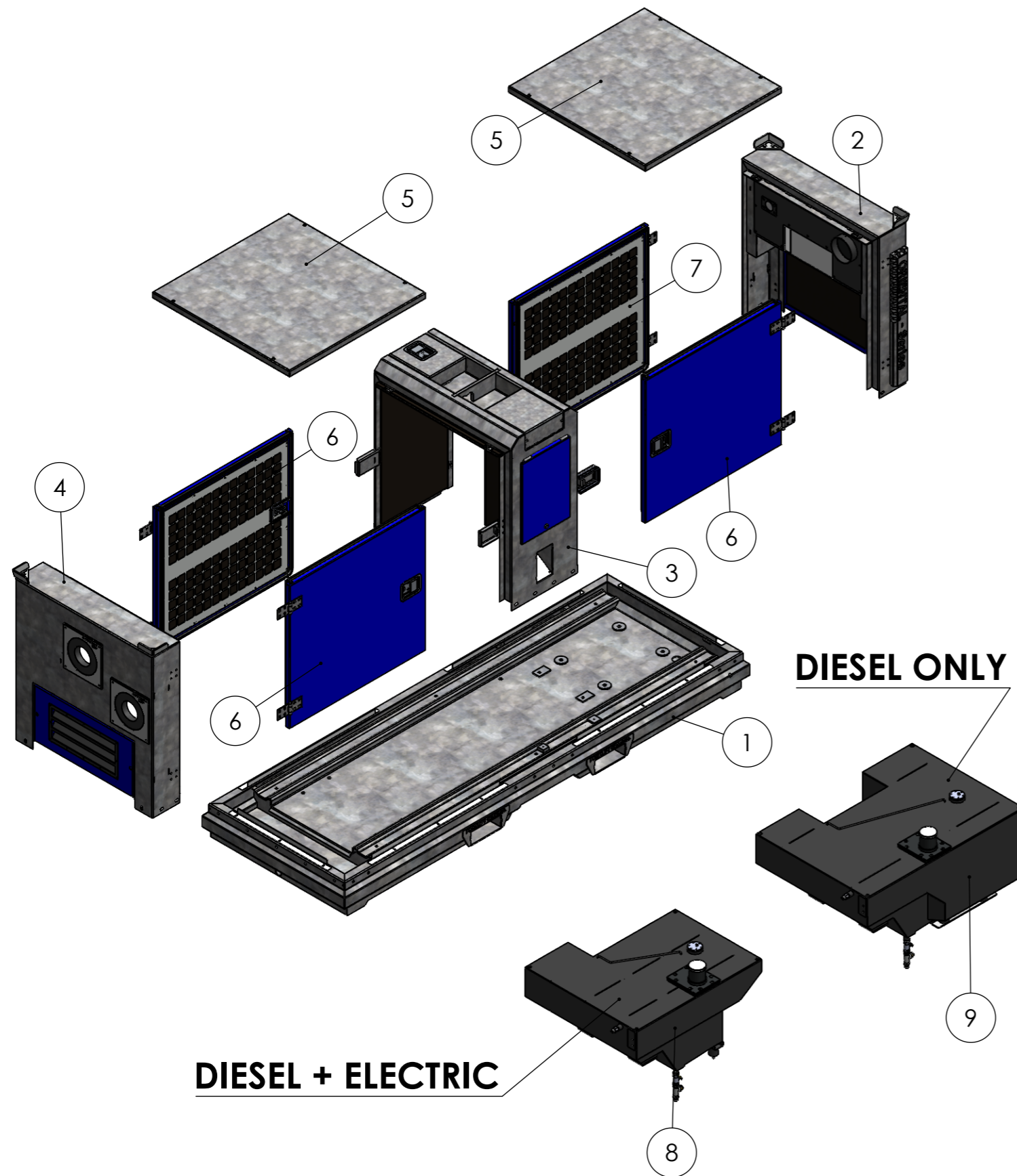

ITEM NO.	PART NUMBER	DESCRIPTION	QTY.
1	31998	UNDER BASE CANOPY ORIENTAL	1
2	32008	PANEL C STANDARD CANOPY ORIENTAL	1
3	32009	MIDDLE PANEL STANDARD CANOPY ORIENTAL	1
4	32010	PANEL D STANDARD CANOPY ORIENTAL	1
5	32011	TOP PANEL CANOPY ORIENTAL 947 mm x 940 mm	2
6	32012	DOOR WITH LOCKER 940 mm x 855 mm COMPLETE ORIENTAL	3
7	32013	DOOR WITHOUT LOCKER 940 mm x 855 mm COMPLETE ORIENTAL	1
8	32095	FUEL TANK ORIENTAL DIESEL-ELECTRIC	1
9	32224	FUEL TANK ORIENTAL DIESEL	1

Revision information				UNSPECIFIED GEOMETRICAL, LINEAR AND ANGULAR TOLERANCE SHALL CONFORM TO ISO 2768-MK (UNLESS OTHERWISE STATED)		format	scale	projection	
Rev	Date	Drn	Appr	Info		A3	1:100		
-	27-02-2025	IL	-			Drawn: IL	web: www.impulsebv.com		
						Date: 27-02-2025	Material:		
						Rev.: -	Weight: 728.50 Kg		
						State: Approved	Treatm.: Assemble		

PDM No. : 35282 Title: STANDARD CANOPY IP-175 ORIENTAL - EXPLODED VIEW

All rights strictly reserved. Reproduction or issue to third parties in any form whatever is not permitted without written authority from the proprietor. Property of Impulse Holding B.V. Copyright Impulse Pumps B.V.