

STANDARD CANOPY IP-PRO YAMUNA SPAREPARTS

REQUEST PARTS ONLINE

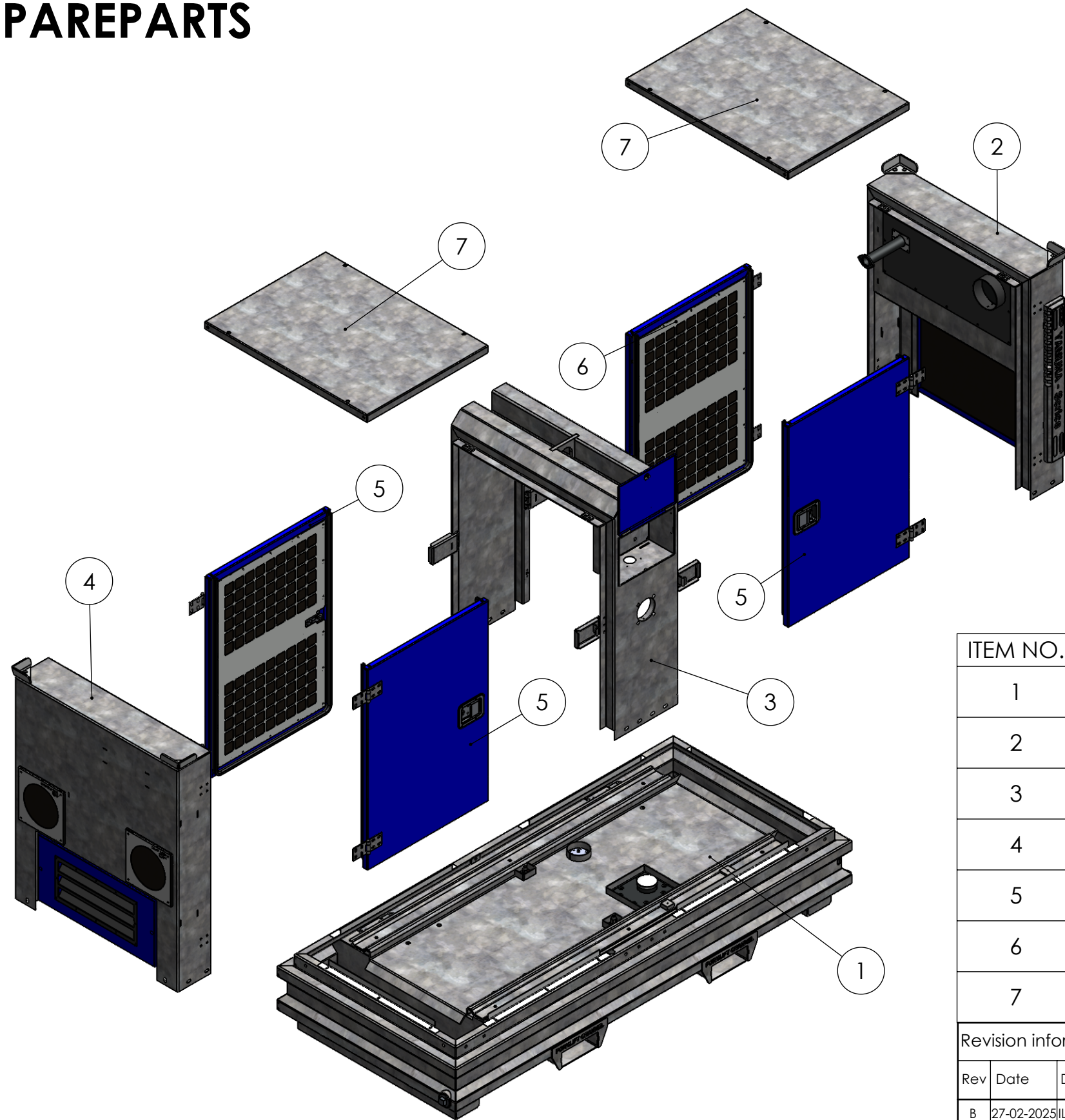

ITEM NO.	PART NUMBER	DESCRIPTION	QTY.
1	20494	UNDER BASE STANDARD CANOPY	1
2	20448	PANEL C STANDARD CANOPY YAMUNA	1
3	30841	MIDDLE PANEL STANDARD CANOPY VERSION II	1
4	32338	PANEL D STANDARD CANOPY YAMUNA	1
5	20380	DOOR WITH LOCKER 1010 mm x 705 mm COMPLETE	3
6	20423	DOOR WITHOUT LOCKER 1010 mm x 705 mm COMPLETE	1
7	20393	TOP PANEL CANOPY 945 mm x 705 mm	2

Revision information					UNSPECIFIED GEOMETRICAL, LINEAR AND ANGULAR TOLERANCE SHALL CONFORM TO ISO 2768-MK (UNLESS OTHERWISE STATED)	format	scale	projection	
Rev	Date	Drn	Appr	Info	A3	1:100			
B	27-02-2025	IL	IL	-	Drawn:	IL	web:	www.impulsebv.com	
A	27-02-2025	IL	IL	-	Date:	12-02-2025	Material:		
-	15-02-2025		JE	-	Rev.:	B	Weight:	660.55 Kg	
					State:	Approved	Treatm.:	Assemble	

PDM No. : 35271 Title: STANDARD CANOPY IP-PRO YAMUNA - EXPLODED VIEW